

Putting your PlantBox together

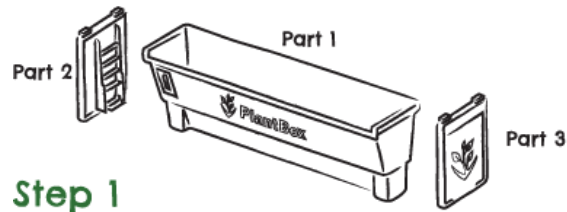

Step 1

Start by putting the sides on the troughs. Clip the sides to the trough by aligning the top first and clicking in at the bottom.

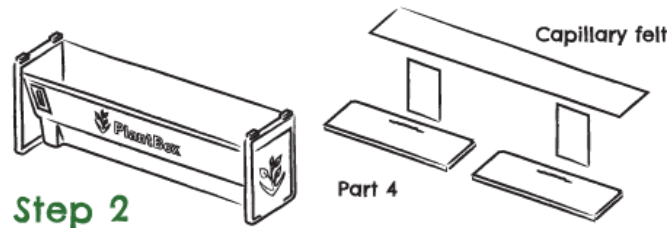

Step 2

Feed the smaller felt tongues through the slots on the shelves, and place both the shelves inside the trough, making sure the slots are at the back. Now overlay the longer felt piece on the shelf.

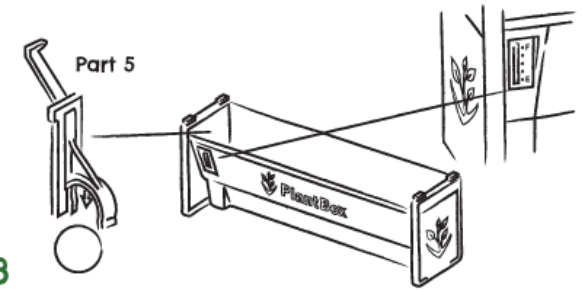

Step 3

Attach the polystyrene float to the float indicator and slot into grooves inside the trough.

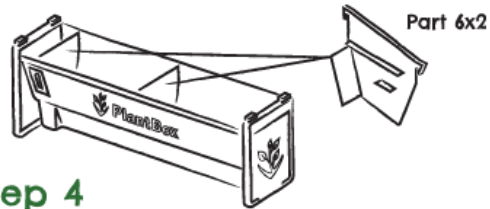

Step 4

Slide divider plates along the trough until both are in position.

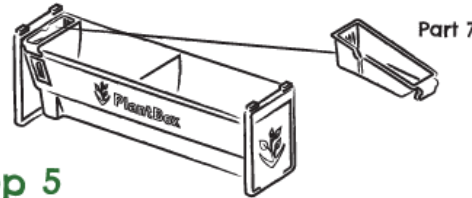

Step 5

Clip in the water filter (this is where you will be filling up shortly!)

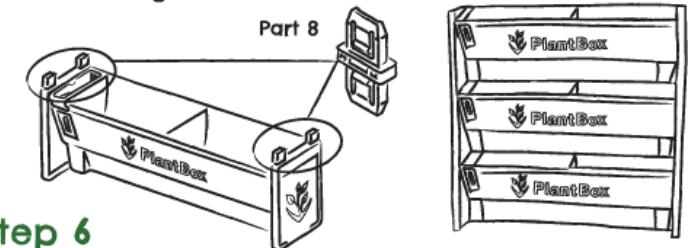

Step 6

Use the small pegs to clip your troughs together and start creating your vertical garden!

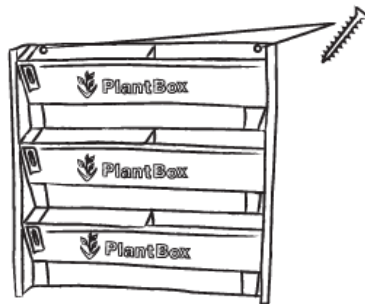

Step 7

Put your PlantBox in position and fix to the wall (we recommend you use a spirit level for this bit!)

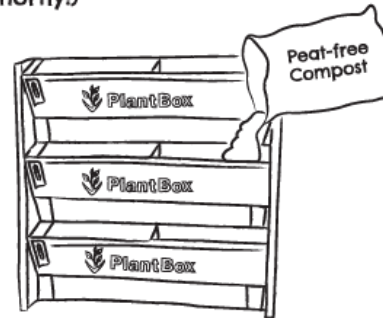

Step 8

Time to add compost, we recommend peat-free compost for best results.

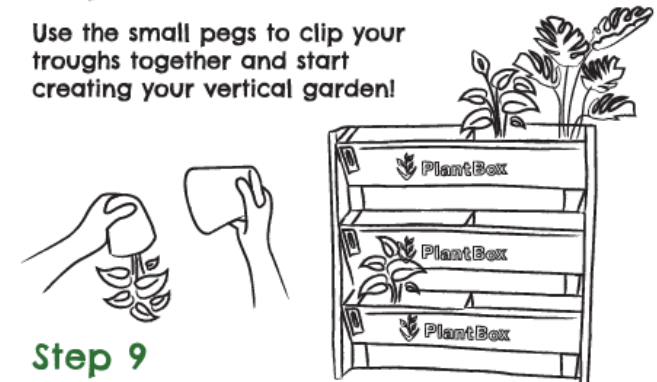

Step 9

Now you can plant anything from seeds to 1 litre pots - creating your vertical garden!

Step 10

Fill your PlantBox from the top trough until the indicator on the bottom trough is showing "Full".



Get inspired at www.growingrevolution.com

! This product requires fixing or anchoring to a suitable wall or structure to avoid serious injury or death. If in doubt about fixings, or if you have specific project requirements, please seek further assistance by contacting one of the team at: plantbox@growingrevolution.com